

# HISTORIC VIRGINIA HALL

DESIGN ♦ CONSTRUCTION ♦ RENOVATION

## Library on a Growing Campus

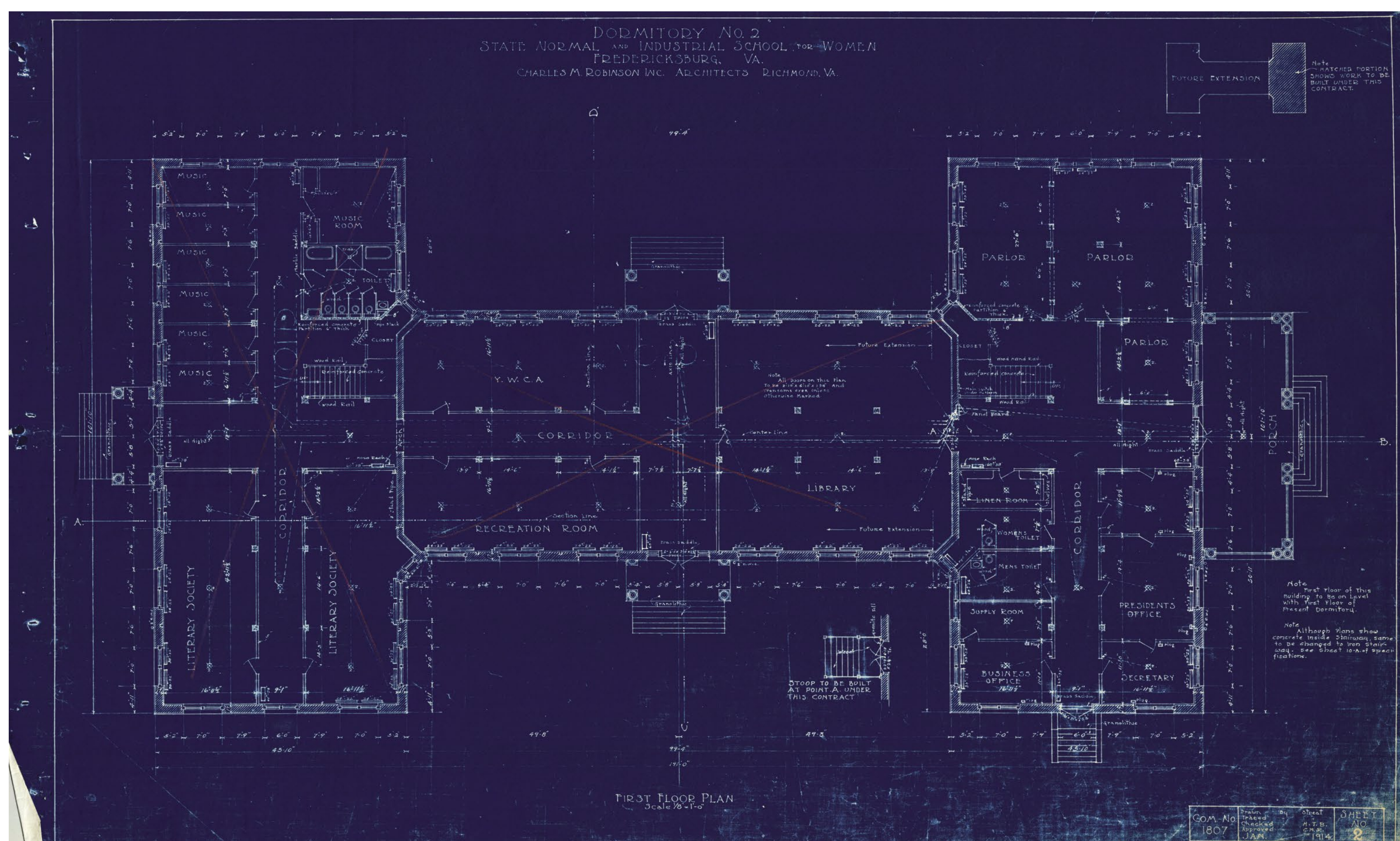

*First floor plan of Virginia Hall as designed by Charles M. Robinson in 1914. In the upper right corner of the drawing (NE corner of the plan) is designated as a parlor, and the library is planned for the center section to be built later.*

*Image: UMW Special Collections*



*The formal parlor in the NW corner of the building when the first of three sections was constructed in 1914. This room was transformed into a library as early as 1921.*

*Image: UMW Special Collections*

The library has always been central to college life at UMW. When Virginia Hall was built in 1914, the space originally designed as a parlor for club meetings (as seen in the 1914 image with potted plants and lots of meeting space), was by 1921 transformed with bookshelf-lined walls and packed study tables into the school's library. By 1926, the library again moved, this time into more spacious quarters in the new center section. The 1914 parlor was repurposed for meeting space until 1934 when the library moved to the new south wing and the parlors were transformed into bedrooms.



*By 1926 the center section of Virginia Hall was built and the planned library was used until 1934 when the south wing was built.*

*Image: UMW Special Collections*

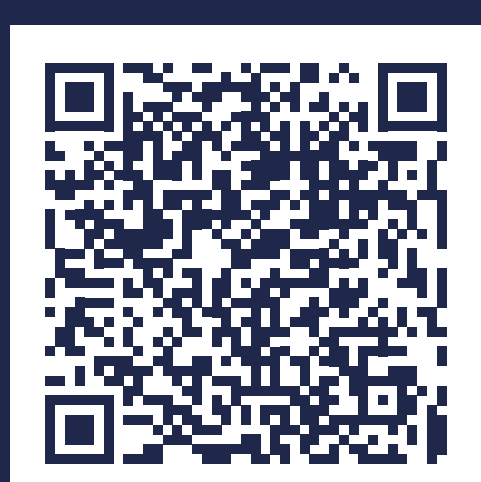

Scan for accessible PDF

