

HISTORIC VIRGINIA HALL

DESIGN ♦ CONSTRUCTION ♦ RENOVATION

Pressing Room and Kitchenette

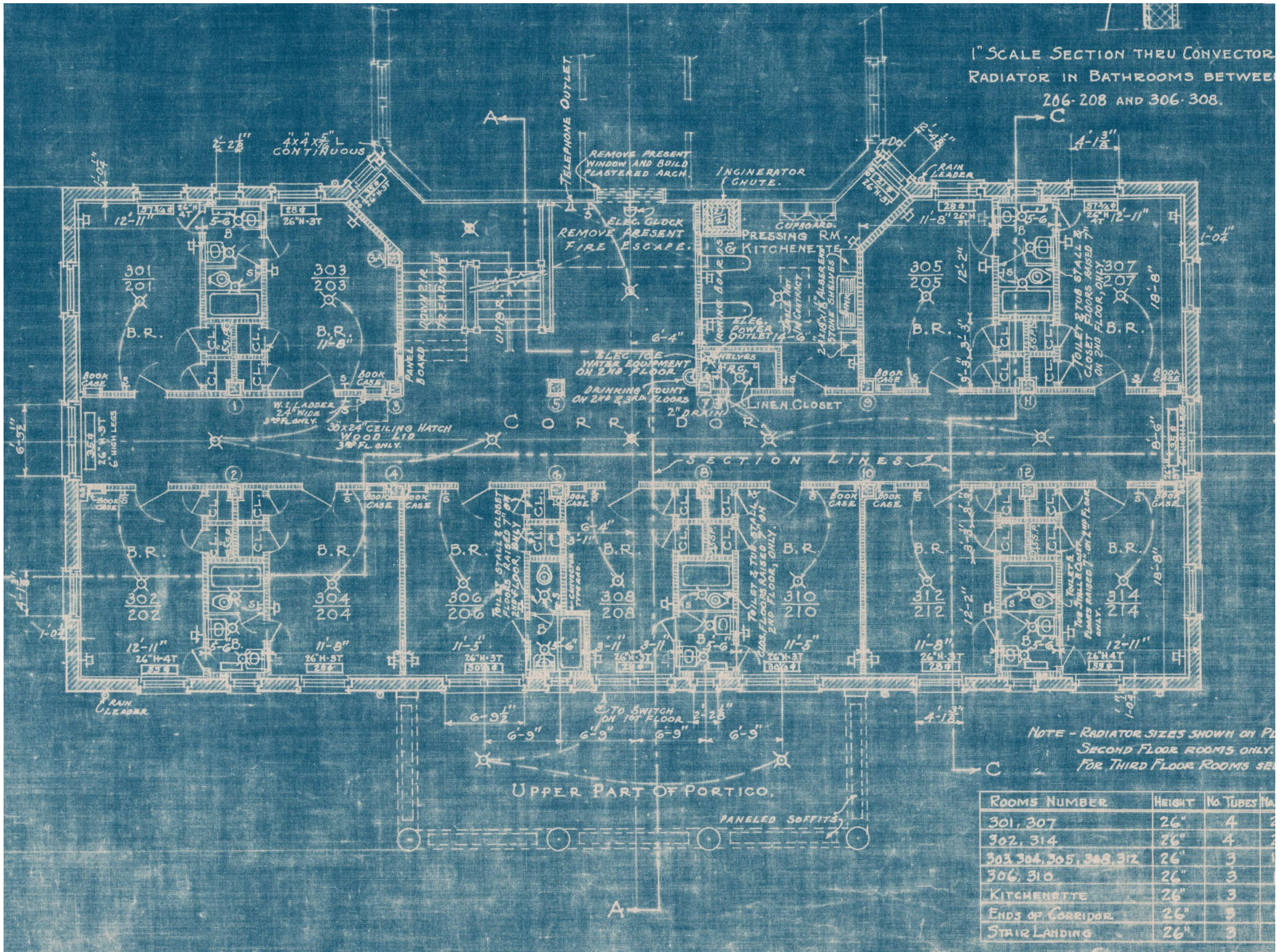

Blueprint for South Wing from 1934 showing Pressing Room and Kitchenette. Note shows that countertops were intended for hot plates. Image: UMW Special Collections

Much like today, small appliances were not allowed in student rooms. In 1934 each floor had a small common room for residents, including a wooden pantry for food storage and folding ironing boards that were hidden in the wall. Stone countertops were installed near the sink for hot plates so student could occasionally make their own meals.

Right: Original 1934 Pantry Cabinet installed in Kitchenette.

Image: Tom Keogh

Far right: Fold-out ironing boards installed in 1934 to help students keep their clothes neatly pressed.

Image: Tom Keogh

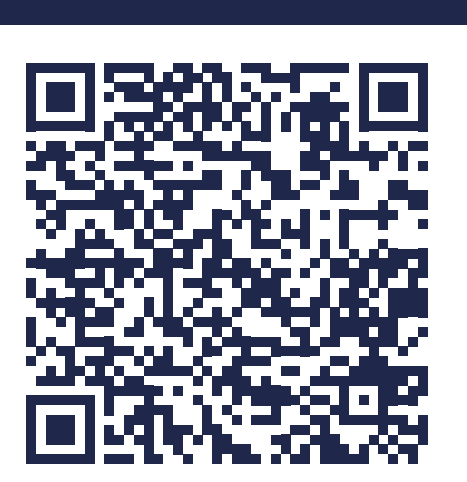

Scan for accessible PDF

